

059198

RECEIVED
LARAMIE COUNTY
CHEYENNE, WY.

CERTIFIED LAND CORNER RECORDATION

'89 JUL 5 PM 3 50

DESCRIPTION OF CORNER EVIDENCE FOUND, AND ORIGINAL RECORD (if known)

Found standard General Land Office brass capped monument at the Northwest corner of Section 29, Township 14 North, Range 70 West of the 6th P.M.

DESCRIPTION OF MONUMENT AND ACCESSORIES ESTABLISHED TO PERPETUATE THE ORIGINAL LOCATION OF THIS CORNER:

SKETCH, WITH COURSE AND DISTANCE TO ADJACENT CORNER IF DETERMINED IN THIS SURVEY.
(May Sketch or Paste Reproduction on Reverse Side.)

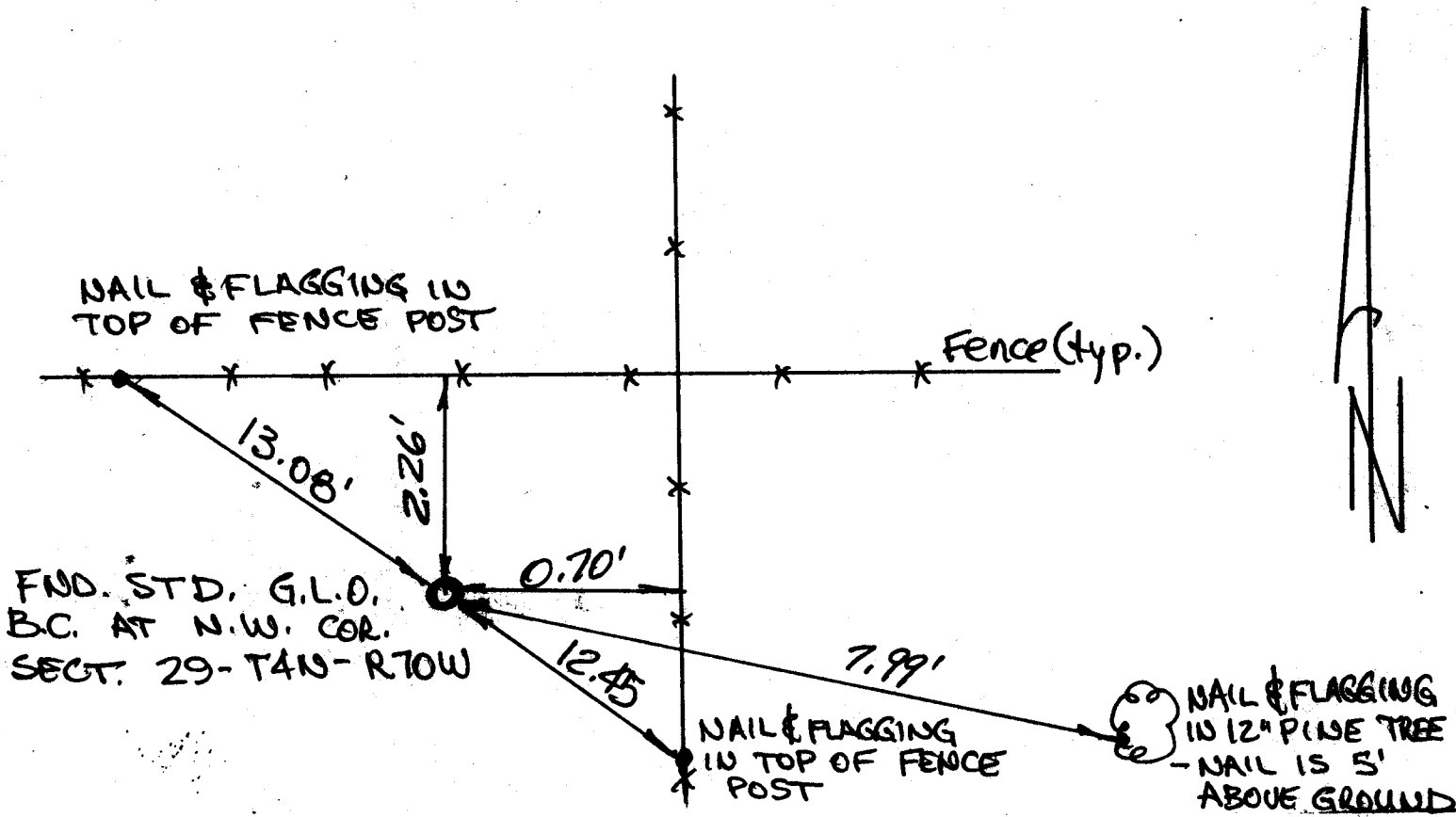

I, EDWARD L. BERLIER certify that I have carefully performed or reviewed the work done on the diagrammed corner as reported on this recordation form and approve the same.

Edward L. Berlier 2930
Signature of Surveyor Registration No.

STATE OF WYOMING,
Office of Clerk and Recorder,
County of _____

This "corner record" was filed for record on the _____ day of _____, 19____, was noted on the cross-index plat and is assigned page No. _____, in book No. _____

Janet C. Whitehead
County Official
Cross Index No. R-5 T. 14 R. 70 Mer.
____ T. _____ R. _____ Mer.
____ T. _____ R. _____ Mer.
____ T. _____ R. _____ Mer.
____ T. _____ R. _____ Mer.
____ T. _____ R. _____ Mer.
____ T. _____ R. _____ Mer.

BOOK 1275

R 5

872